



Project Description

Waterfront City is a master-planned mixed-use community located on the 700-berth La Marina Joseph Khoury opposite the Dbayeh area of Lebanon, and overlooking the Mediterranean Sea. The site is only 15 minutes away from Downtown Beirut. This much anticipated project is being developed in collaboration between Majid Al Futtaim Properties and Ste Joseph G. Khoury et Fils Holding, combining the scale and expertise of one of the largest regional developers with the local experience and history of Lebanon. The initial first phase will include 7 beautifully spaced buildings offering 270 apartments, various retail shops, health club, parks and a marina front promenade. And with a significant upgrade to all public infrastructure, such as roads, walkways, lighting and security, residents will enjoy a pleasant living environment in a unique Lebanese community.

**RETAIL
180,000 SQM**

DPM Roles & Services

We combined the architectural, structural services to offer our clients a complete pre-construction model of the buildings with the added fourth element of Time, hence 4D modeling.

We created building information modeling (BIM) 4D Model in a digital construction site providing insight into entire Buildings Life Cycle Management.

Client Presentation and Support at meetings.

**THE PROMENADE – WATERFRONT CITY
DBAYEH - LEBANON**



4D CONSTRUCTION SIMULATION

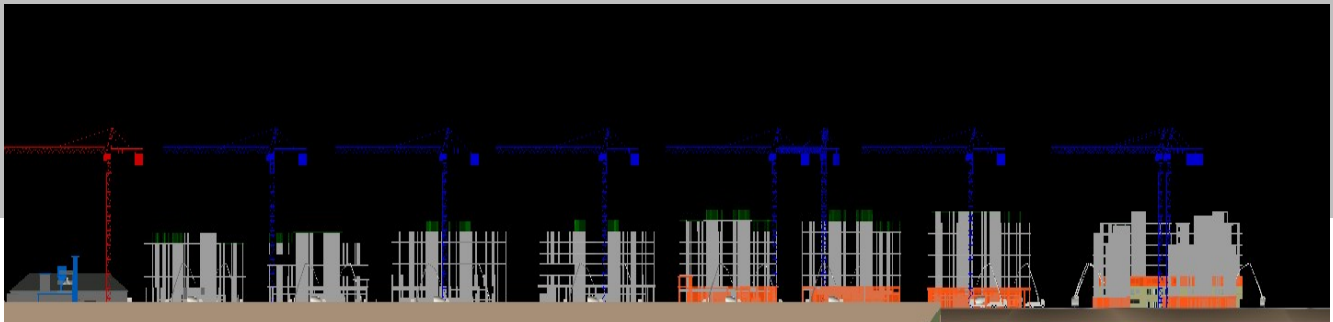

**RETAIL
180,000 SQM**

DPM Roles & Services

Working closely with your team, DPM Construction Management Services will tailor a solution for your project-specific needs. For each project stage, starting from business development, through pre-construction, to actual construction, DPM experts deliver an end-to-end integrated construction service.

**A 3D Construction Model / A 4D Model showing the construction sequence
A 5D Model that adds the costs and actual, to create a model and schedule linked to Earned Value Analysis.**

**THE PROMENADE – WATERFRONT CITY
DBAYEH - LEBANON**